

#58

# KING STUD/WIND BRACING ATTACHMENT

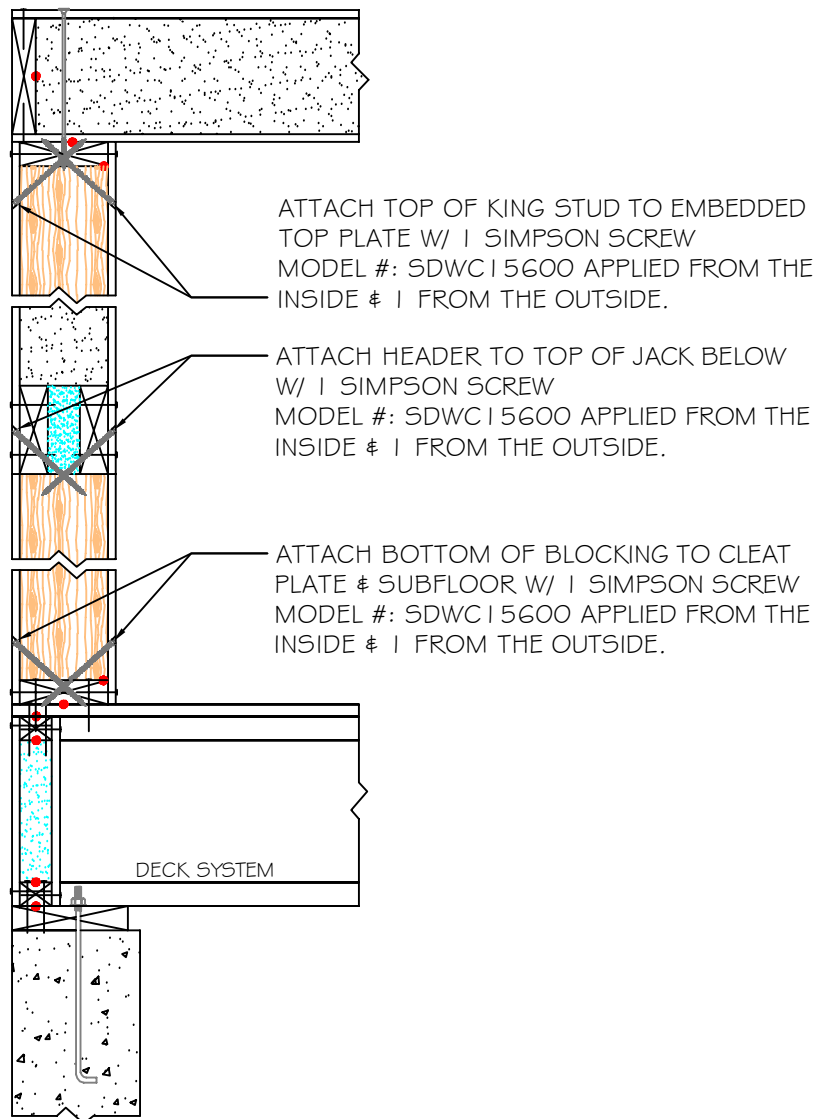

NOTE: ALL RED DOTS - APPLY CONTINUOUS  $\frac{3}{8}$ " DIA. BEAD OF MASTIC SEALANT AT WOOD & FOAM & WOOD TO WOOD CONNECTIONS AT INTERIOR SIDE.

DETAILS ARE TYPICAL OF STANDARD CONDITIONS AND MAY NOT APPLY TO ALL PROJECTS. REFER TO FINAL PROJECT APPROVAL DRAWINGS FOR SPECIFICATIONS. PLEASE CONTACT FPI TECHNICAL DEPARTMENT FOR QUESTIONS AND/OR CONCERNS.

KING STUD & WIND BRACING ATTACHMENT  
SCALE: 1" = 1'-0"

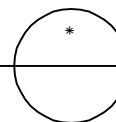

**Foard**  
PANEL

STRUCTURAL INSULATED PANELS  
P.O. Box 185, 53 Slow Drive, W. Chesterfield, NH 03466

[WWW.FOARDPANEL.COM](http://WWW.FOARDPANEL.COM)

(800) - 644 - 8885