

#56

BEAM POCKET PERSPECTIVE DETAIL

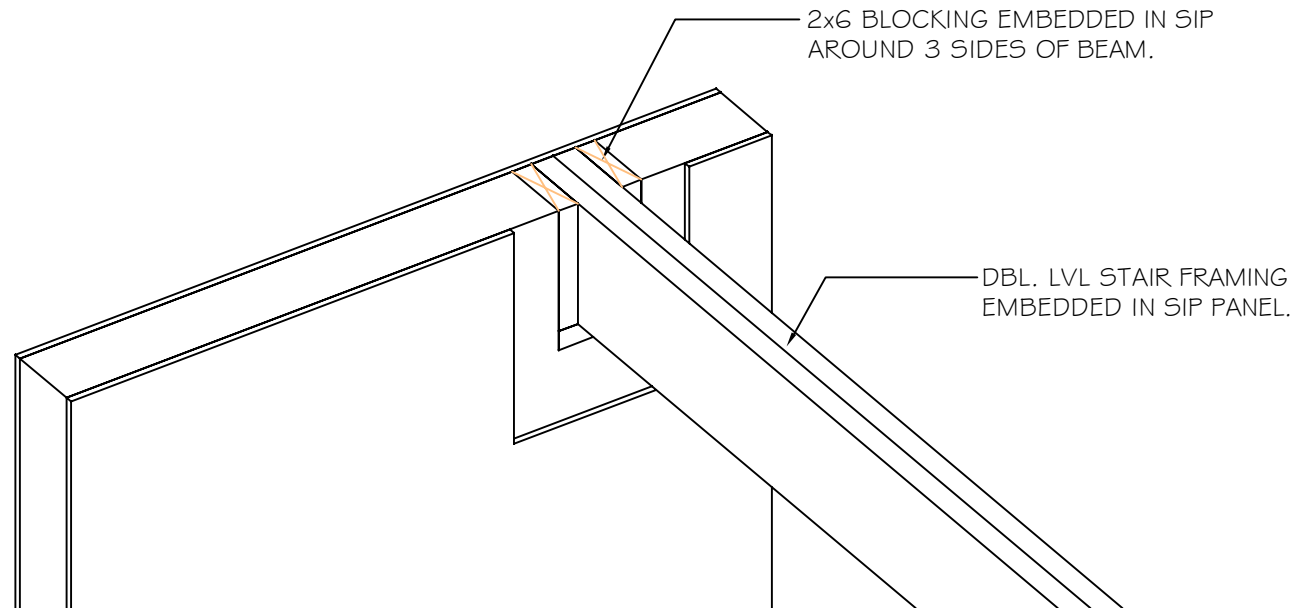

NOTE: INT. PANEL SKIN HELD BACK FOR DRAWING CLARITY.

- * INSTALL COLUMN UNDER BEAM (IF REQUIRED) IN PANEL PER TYPICAL DETAILS.
- * CUT OPENING THROUGH INTERIOR SKIN THE SAME SIZE AS THE SUPPORT BEAM.
- * REMOVE AREA OF FOAM LEAVING EXTERIOR SKIN FULLY INTACT, THEN FULL ROUT EDGES OF POCKET.
- * PAD SIDES OF BEAM END W/ 2X BLOCKING SIZED TO FIT INTO PANEL CORE.
- * LAND BEAM INTO POCKET SO THAT 2X BLOCKING KEYS BETWEEN BOTH PANEL SKINS. SECURE OSB PANEL SKINS, BOTH INTERIOR & EXTERIOR TO BLOCKING.
- * USE DRILL & FILL METHOD TO APPLY EXPANDING SEALANT THROUGHOUT ANY CREATED VOIDS.
- * ALSO FASTEN INTO END GRAIN OF SUPPORT BEAM THROUGH EXTERIOR SKINS.

BEAM POCKET PERSPECTIVE DETAIL

SCALE: 1" = 1'-0"

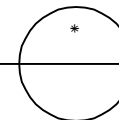

DETAILS ARE TYPICAL OF STANDARD CONDITIONS AND MAY NOT APPLY TO ALL PROJECTS. REFER TO FINAL PROJECT APPROVAL DRAWINGS FOR SPECIFICATIONS. PLEASE CONTACT FPI TECHNICAL DEPARTMENT FOR QUESTIONS AND/OR CONCERNS.

Foard
PANEL

STRUCTURAL INSULATED PANELS
P.O. Box 185, 53 Slow Drive, W. Chesterfield, NH 03466

WWW.FOARDPANEL.COM

(800) - 644 - 8885