

#18

# PANEL TO 2nd FLOOR DECK CONNECTION

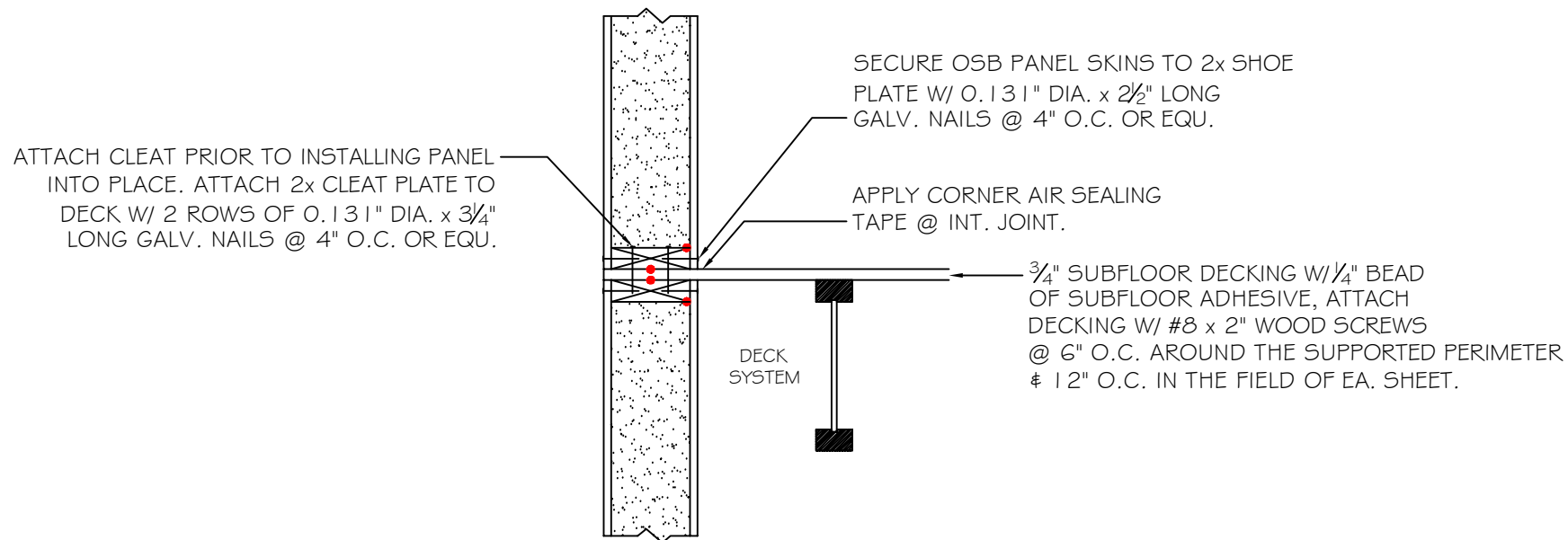

NOTE: ALL RED DOTS - APPLY CONTINUOUS 3/8" DIA. BEAD OF MASTIC SEALANT AT WOOD TO FOAM & WOOD TO WOOD CONNECTIONS AT INTERIOR SIDE.

DETAILS ARE TYPICAL OF STANDARD CONDITIONS AND MAY NOT APPLY TO ALL PROJECTS. REFER TO FINAL PROJECT APPROVAL DRAWINGS FOR SPECIFICATIONS. PLEASE CONTACT FPI TECHNICAL DEPARTMENT FOR QUESTIONS AND/OR CONCERNS.

2nd FLOOR DECK ATTACHMENT DETAIL

SCALE: 1" = 1'-0"

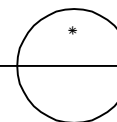

**Foard**  
PANEL

STRUCTURAL INSULATED PANELS  
P.O. Box 185, 53 Slow Drive, W. Chesterfield, NH 03466

[WWW.FOARDPANEL.COM](http://WWW.FOARDPANEL.COM)

(800) - 644 - 8885